

MLM WALL THERMOSTAT 2

15

-  ACCURATE ROOM TEMPERATURE SENSING
-  EASY ROOM TEMPERATURE ADJUSTMENT
-  MLM & MLC COMPATIBLE
-  NEW MODERN SLIM DESIGN
-  EASY PHYSICAL MOUNTING

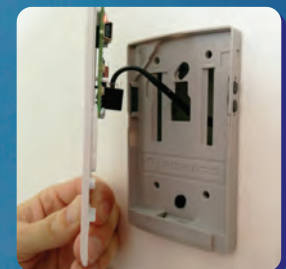

FEATURES

The Rickard MLM/MLC Wall Thermostat has been designed to give the user individual temperature control and accurate room temperature sensing in an elegant and easy to install package. The thermostat converts any slave diffuser into a master so that it can control a zone of up to 15 diffusers. The new design boasts a modern, slim body, a larger digital screen for easier reading and discreet buttons on each side for temperature adjustment and advanced user control.

AESTHETICS

DISPLAY BUTTONS

The Rickard Wall Thermostat has been designed with discreet buttons located on either side of its body. One side allows straight forward temperature adjustment and the other advanced user control.

Right Hand Side Buttons

The buttons located on the right hand side adjust the temperature up or down. The Up button increases and the Down button decreases the temperature set point.

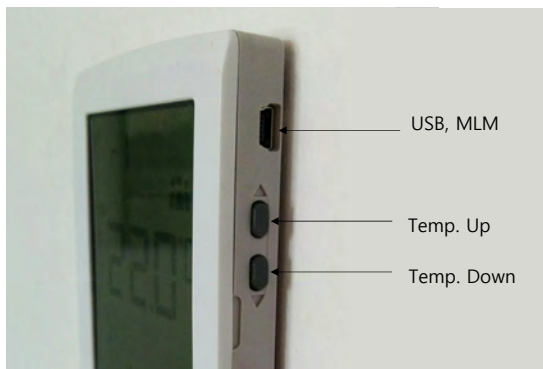

Left Hand Side Buttons

The buttons located on the side left hand side give the installer access to advanced commissioning functions. The Menu button is located above the Enter Button. Standard symbols depict Menu and Enter. Each press of the Menu buttons cycles through each option, the up and down buttons adjust the value and the enter button writes the value to memory.

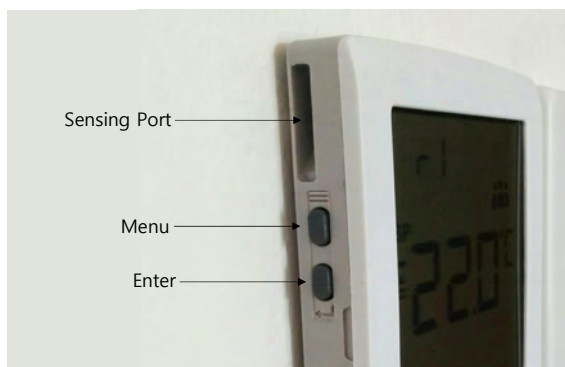

DISPLAY OPTIONS

FUNCTIONAL EDITING OPTIONS

1. **Set point Display:** When activated Set point is displayed instead of room temperature.

2. **Edit Set point Disable:** When activated, the user is prevented from editing set point.
3. **Setup Menu Enabled:** When activated, the user has access to the Setup Menu.

SENSING ACCURACY

The Rickard MLM Wall Thermostat has a built in sensing port designed to accurately sample room temperature.

NOTE: Consider the effect of a hot or cold wall on the Wall Thermostat's sensing accuracy. External conditions can affect internal wall temperatures to such a degree that the Wall Thermostat's sensing ability is also affected. Mount the Wall Thermostat on an opposite or adjacent wall.

CONTROLS

1. Standard Wall Thermostat (Compatible with MLM or MLC).
2. Wall Thermostat with Occupancy Sensing: Comes with an Occupancy Sensor fitted. Occupancy Sensing saves fan energy by closing the diffuser and switches lighting (Rickard light switching module required) when the Wall Thermostat detects the room is unoccupied (Compatible with MLM only).

INSTALLATION

The Rickard MLM Wall Thermostat is simple to install. It has been designed to be fitted to a standard 2 x 4 draw box or dry wall partitioning. To attach to a draw box use the 2 machine screws supplied. The diagonal slots allow horizontal and vertical alignment. Four additional round holes can be used for dry wall partitioning attachment. The Thermostat comes with a 8 meter RJ12 cable for connection to a slave diffuser.

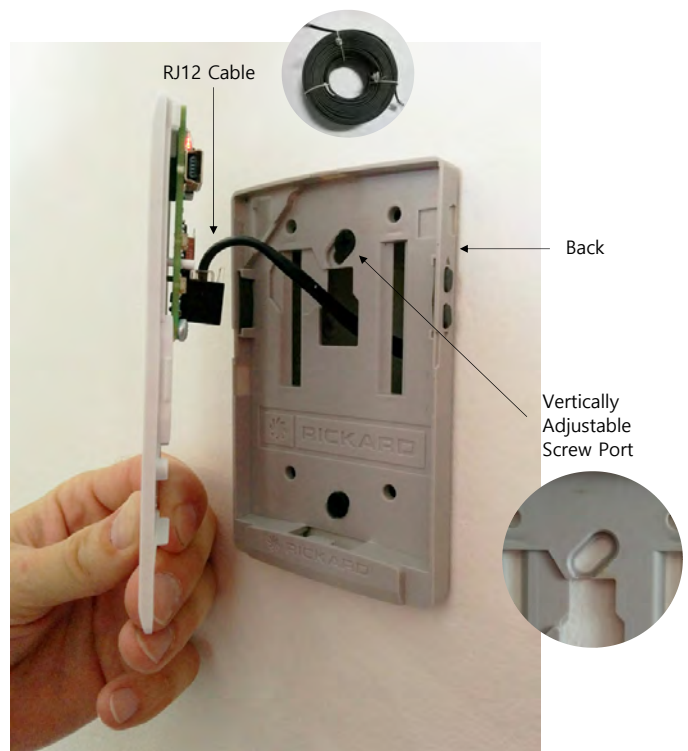

APPLICATION

The Rickard MLM Rickard Wall Thermostat;

- Accurately senses and sets room temperature.
- Converts any Slave diffuser into a Master so that it can control a zone of up to 15 diffusers.
- Compatible with MLM and MLC systems.
- Accesses and adjusts advanced commissioning settings.

SELECTION

Used when floor layout plans are less likely to change and sensing accuracy is a priority.

ACCURACY

Consider the effect of a hot or cold wall on the Wall Thermostat's sensing accuracy. External conditions can affect internal wall temperatures to such a degree that the Wall Thermostat's sensing ability is also affected. Mount the Wall Thermostat on an opposite or adjacent wall.

TYPES

1. **Std. Wall Thermostat** (Compatible with MLM or ML Controls).

2. **Wall Thermostat with Occupancy Sensing:** Comes with an Occupancy Sensor fitted to the face of the wall thermostat as shown below. Occupancy Sensing saves fan energy by closing the diffuser when the Wall Thermostat detects the room is unoccupied (Compatible with MLM only). After a delay (15 minutes by default) the diffuser will first move the control damper to the minimum air position, if the room remains unoccupied for a further 15 minutes (adjustable), the control damper will close. As soon as the room is occupied again, the diffuser will activate the control damper and bring the room back into control.

